

NOTE:  
REFER TO PAGE 11 FOR DOOR SCHEDULE  
REFER TO PAGE 12 FOR WINDOW SCHEDULE

**BASIX COMMITMENTS:**  
NEW OR ALTERED SHOWERHEADS MUST HAVE A FLOW RATE NO GREATER THAN 9L PER MINUTE OR A 3 STAR WATER RATING.  
NEW OR ALTERED TOILETS MUST HAVE A FLOW RATE NO GREATER THAN 4L PER MINUTE OR A MINIMUM 3 STAR WATER RATING.  
NEW OR ALTERED TAPS MUST HAVE A FLOW RATE NO GREATER THAN 9L PER MINUTE OR MINIMUM 3 STAR WATER RATING.

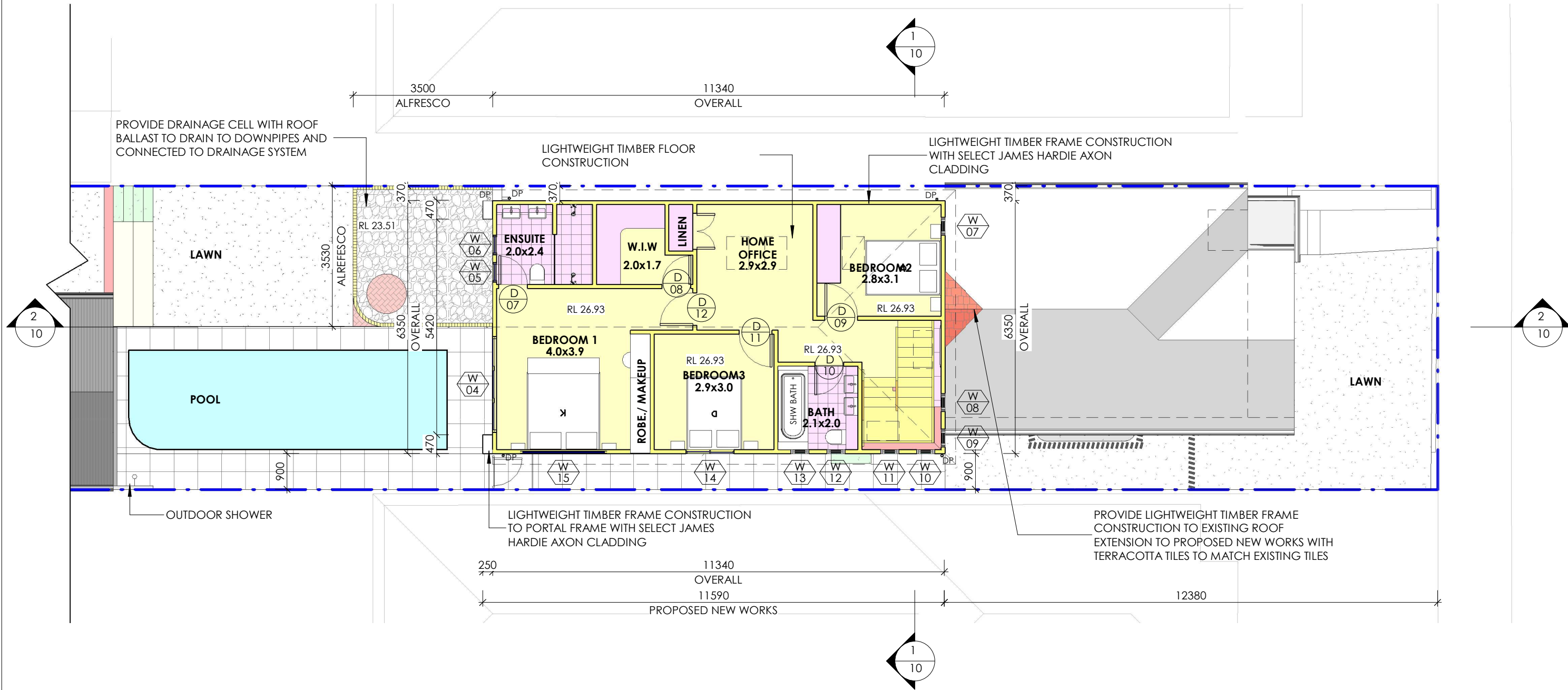

# 1 PROPOSED FIRST FL

1 : 100

B	DEVELOPMENT APPLICATION	06-06-2022	DP	RO, EJS
A	CONCEPT DESIGN	26-04-2022	DP	RO, EJS
ISSUE	AMENDMENTS	DATE	DRN	CHK

CLIENT  
Mr & Mrs Ferrara

ADDRESS  
26 Second St, Ashbury

PROJECT  
ALTERATIONS & ADDITIONS

PROJECT STATUS  
DEVELOPMENT APPLICATION

DRAWING TITLE  
PROPOSED FIRST FLOOR PLAN

SHEET NO: 05  
SCALE: 1 : 100@A3  
DESIGN: DP  
ISSUE: B  
JOB NO: 888-1657  
DRAWN: DP  
CHECKED: RO, EJS

DS407  
DESIGN STUDIO

P PO Box 141 Earlwood NSW 2206.  
E admin@designstudio407.com.au  
W www.designstudio407.com.au

T (02) 9558 8944  
F (02) 9558 9765

Master Builders Association  
Member  
Australian Institute of Architects

COPYRIGHT of designs shown hereon is retained by DESIGN STUDIO 407. Authority is required for any reproduction.  
Contractor(s) to verify all dimensions on site before commencing work. Figured dimensions given are to be taken in preference to scaling.

Rod O'Laco: Nominated Architect NSW A.R.B. 6520.